

DERIVAZIONE A "T" VERTICALE VERSO L'ALTO CON VARIAZ. PIANO

Rising vertical "T" derivation with plane variation

44

S

V

I

Z

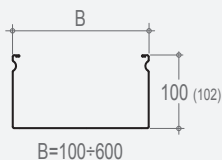
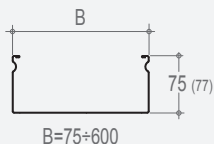
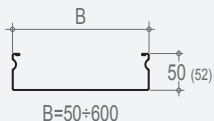
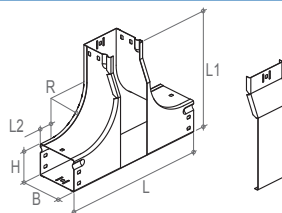
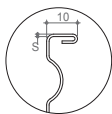
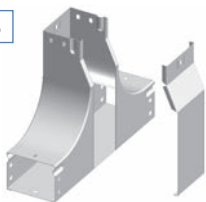

S	V	I	Codice/ Code	S mm	Δ kg/pz
A3	□	44F1B050D	0,8	0,85	
A3	□	44F1B075D	0,8	1,09	
A3	□	44F1B100D	0,8	1,29	
A3	□	44F1B150D	0,8	1,73	
A3	□	44F1B200D	0,8	2,36	
A3	□	44F1B300D	0,8	3,69	
A3	□	44F1B400F	1,0	5,84	
A3	□	44F1B500F	1,0	8,57	
A3	□	44F1B600F	1,0	11,48	

A3	□	44F1C075D	0,8	1,10
A3	□	44F1C100D	0,8	1,41
A3	□	44F1C150D	0,8	1,82
A3	□	44F1C200D	0,8	2,55
A3	□	44F1C300D	0,8	3,75
A3	□	44F1C400F	1,0	6,13
A3	□	44F1C500F	1,0	8,76
A3	□	44F1C600F	1,0	11,71

A3	□	44F1D100D	0,8	1,52
A3	□	44F1D150D	0,8	1,92
A3	□	44F1D200D	0,8	2,55
A3	□	44F1D300D	0,8	3,84
A3	□	44F1D400F	1,0	6,44
A3	□	44F1D500F	1,0	8,75
A3	□	44F1D600F	1,0	11,88

B	H	L	L1	L2	R
050	52	310	205	30	100
075	52	335	240	30	100
100	52	360	240	30	100
150	52	410	240	30	100
200	52	460	240	30	100
300	52	560	240	30	100
400	52	660	290	30	100
500	52	760	340	30	100
600	52	860	390	30	100

075	77	335	265	30	100
100	77	360	265	30	100
150	77	410	265	30	100
200	77	460	265	30	100
300	77	560	265	30	100
400	77	660	315	30	100
500	77	760	365	30	100
600	77	860	415	30	100

100	102	360	290	30	100
150	102	410	290	30	100
200	102	460	290	30	100
300	102	560	290	30	100
400	102	660	340	30	100
500	102	760	390	30	100
600	102	860	440	30	100

Δ	S	Z	Codice/ Code
1,10	0,9	A3 Z	44F1B050E
1,35	0,9	A3 Z	44F1B075E
1,60	0,9	A3 Z	44F1B100E
2,14	0,9	A3 Z	44F1B150E
2,92	0,9	A3 Z	44F1B200E
4,57	0,9	A3 Z	44F1B300E
6,37	1,0	A3 Z	44F1B400F
9,34	1,0	A3 Z	44F1B500F
12,51	1,0	A3 Z	44F1B600F

1,36	0,9	A3 Z	44F1C075E
1,74	0,9	A3 Z	44F1C100E
2,25	0,9	A3 Z	44F1C150E
3,16	0,9	A3 Z	44F1C200E
4,64	0,9	A3 Z	44F1C300E
6,68	1,0	A3 Z	44F1C400F
9,55	1,0	A3 Z	44F1C500F
12,76	1,0	A3 Z	44F1C600F

1,98	0,9	A3 Z	44F1D100E
2,38	0,9	A3 Z	44F1D150E
3,16	0,9	A3 Z	44F1D200E
4,75	0,9	A3 Z	44F1D300E
7,02	1,0	A3 Z	44F1D400F
9,54	1,0	A3 Z	44F1D500F
12,95	1,0	A3 Z	44F1D600F

□ Scegli il materiale/ Choose the material